

## Mount the Camera on the Wall

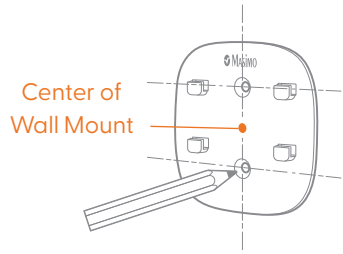

- 1 Place the camera mount on the wall with the center of the mount 4-5 feet above the crib mattress, near the center of the crib. Make sure the wall mount is level and the 4 hooks are facing up, then mark the locations of the screw holes.



- 2 Drill the 2 marked locations with a 1/4" (6mm) drill bit.

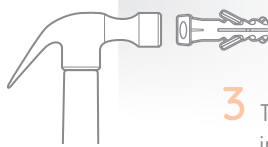

- 3 Tap the 2 wall anchors into the holes until they are flush with the wall.

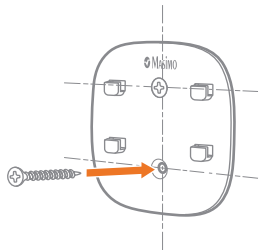

- 4 Secure the mounting plate onto the wall with the included screws.

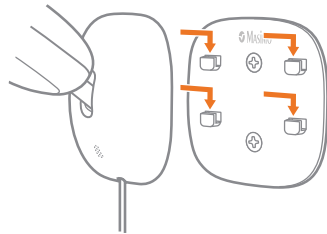

- 5 Align the 4 holes on the camera base with the hooks on the mounting plate, slide the camera down to snap it in place.

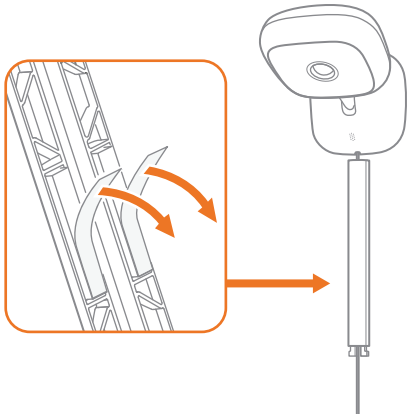

- 6 Peel off the sticky pad liners on the back of the cable cover(s) to apply, starting at the camera. Add more covers as needed.

## Quick Start Guide

stork™ camera

### What's in the box?

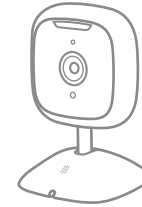

Camera

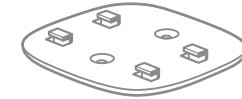

Camera Mount

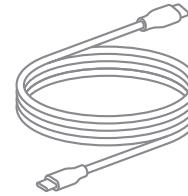

Camera Power Cable



12W Camera Power Adapter

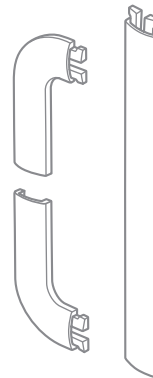

Camera Cable Covers  
Right Elbow x 1  
Left Elbow x 1  
Straight x 18

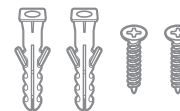

2 Wall Anchors and 2 Screws

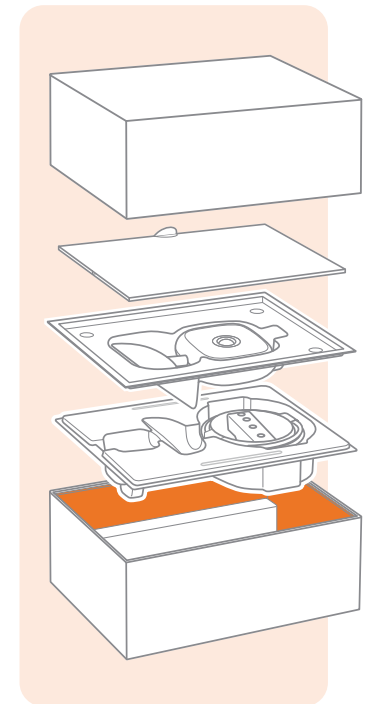

Not intended for use as a medical device or to replace a medical device. Do not use it to diagnose, cure, treat, alleviate, or prevent any disease or health condition.

## Set up the camera

The Stork Camera can be set on a flat surface or mounted to the wall (preferred). If set on a flat surface, place the camera in a safe location so as not to fall on anyone, and where alert sounds can be heard clearly.

For wall mounting, pick a spot on the wall near the crib that is 4 to 5 feet above the mattress. Ideally, it should be located somewhere near the middle of the crib. At this height, the camera can monitor the whole crib. The camera needs to be located within reach of a wall outlet using the included power cable.

No matter the camera location, the camera can be rotated and tilted forward or backward if you need to adjust the view.

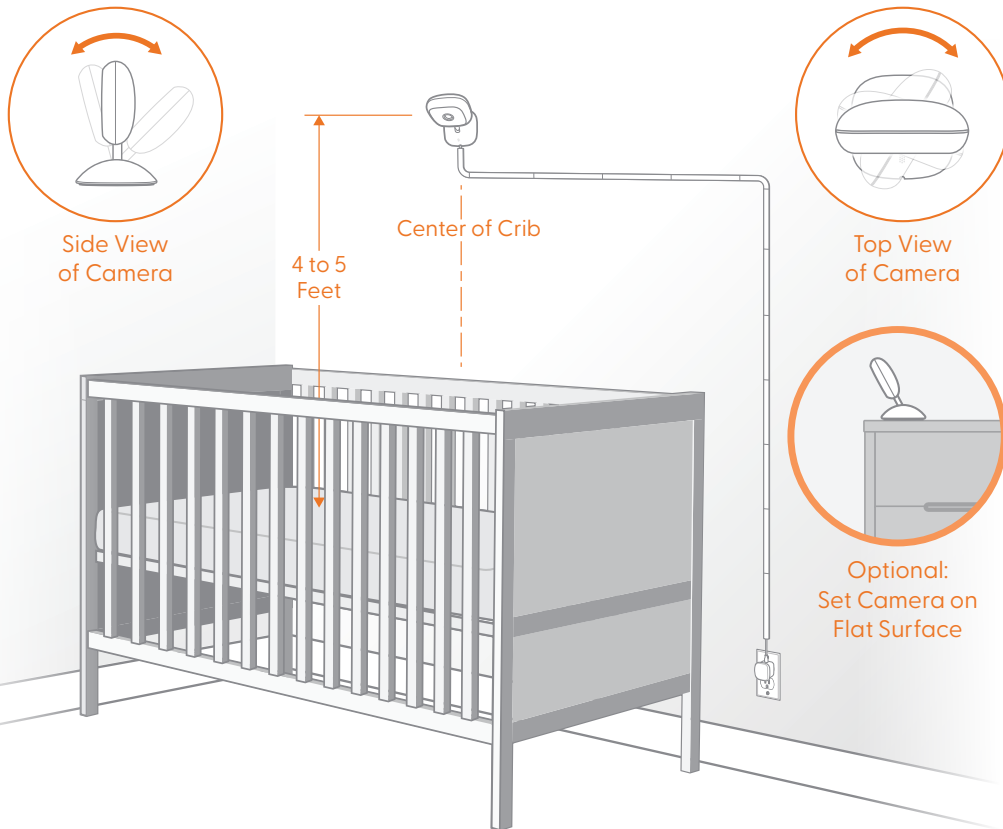

### OWNER'S MANUAL

Refer to the online manual for other functions, information, and operation details.  
[masimostork.com/camera-user-manual](https://masimostork.com/camera-user-manual)



## Attach USB Cable to Camera

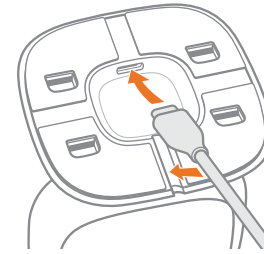

Plug the USB-C cable into the bottom of the camera.

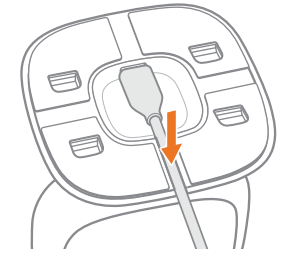

Press the cable down to secure it in the built-in channel.

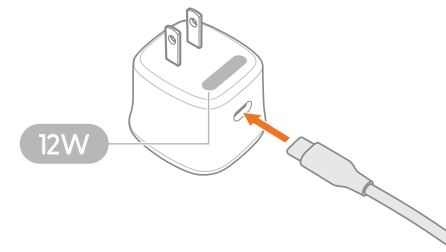

Plug the other end of the USB-C cable into the 12W power adapter.

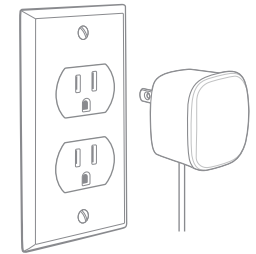

Plug the camera into a wall socket.

## Pair camera to the app

Download the Stork app and follow instructions.

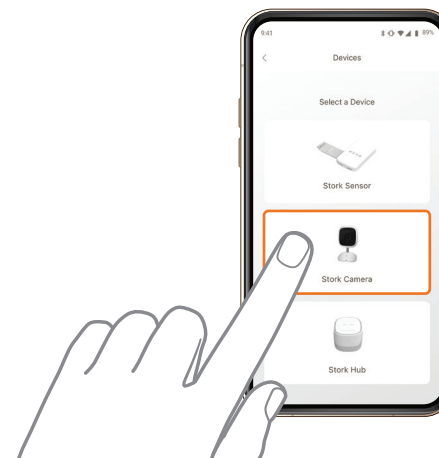

The app screens shown in this document might differ from the actual ones displayed in the app.